

Permitted Cultivation Warehouse

AVAILABLE FOR LEASE IN PHOENIX

4 6 3 6 N O R T H 4 3 R D A V E N U E | P H O E N I X , A R I Z O N A



Property Features:

- **Lease Rate:** \$1.50/sf - \$1.75/sf NNN
- **TI Allowance:** Negotiable
- **Available Square Footage:** ±52,000 SF
- **City of Phoenix Use Permit in Place:** Approved for Cultivation and Manufacturing
- **Power:** 3600 Amps available early 2023
*Additional power can be supplemented by generators
- **Clear Height:** 14'-18'
- **Fire Sprinklers:** In Place



for further information contact

Patrick Moroney

602.684.6271

patrick.moroney@zonedproperties.com

ZONED
PROPERTIES BROKERAGE, LLC

8360 East Raintree Drive
Suite 230
Scottsdale, Arizona 85260
ZonedProperties.com

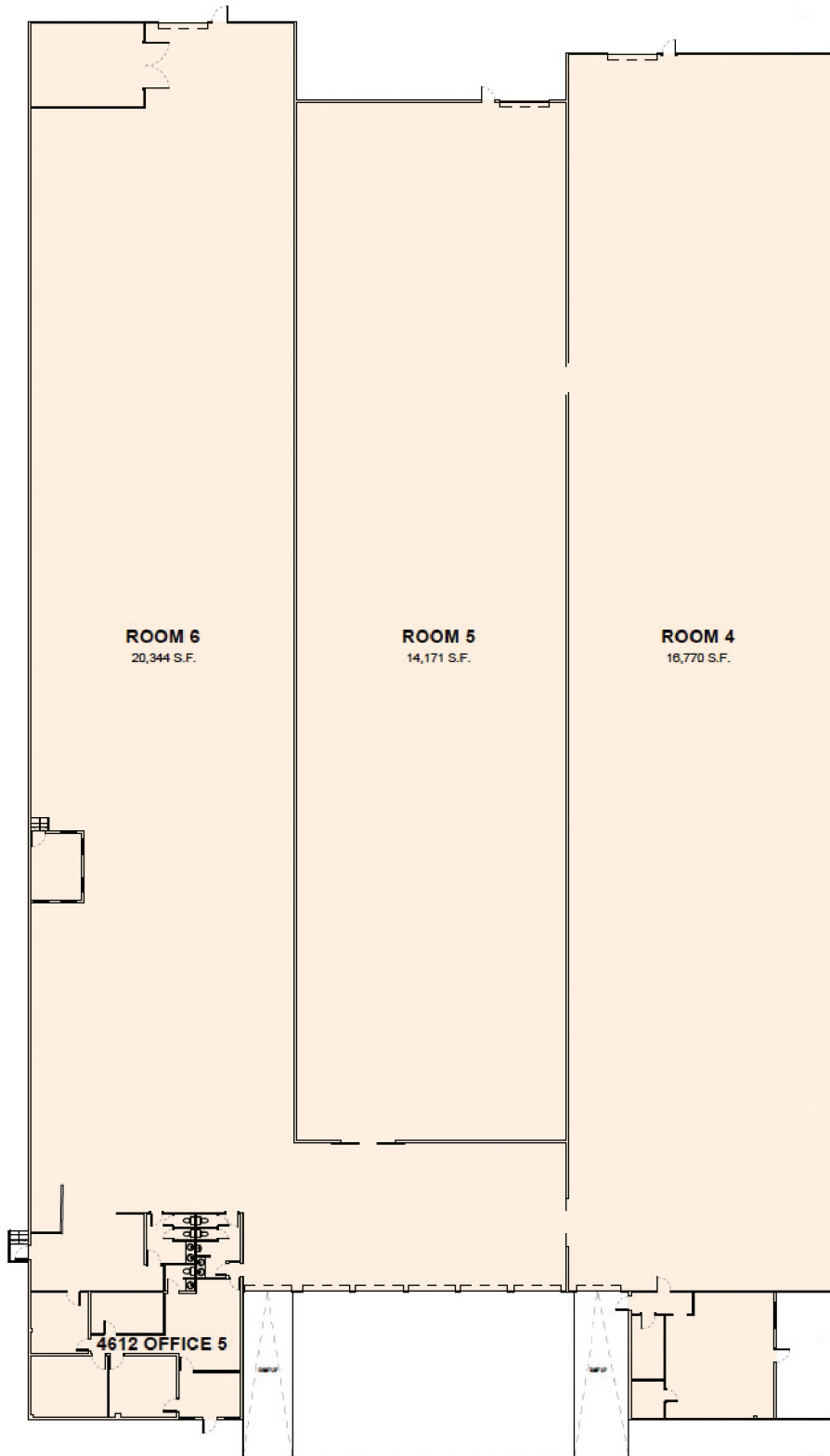

Building - ±55,000 SF

for further information contact

Patrick Moroney

602.684.6271

patrick.moroney@zonedproperties.com

ZONED
PROPERTIES BROKERAGE, LLC

8360 East Raintree Drive
Suite 230
Scottsdale, Arizona 85260
ZonedProperties.com

Interior Photos



for further information contact

Patrick Moroney

602.684.6271

patrick.moroney@zonedproperties.com

ZONED
PROPERTIES BROKERAGE, LLC

8360 East Raintree Drive
Suite 230
Scottsdale, Arizona 85260
ZonedProperties.com